

New PRO9 and PRO9FXL Air Cooled Pro-Grip™ TIG Welding Torch

Rating: 125A DC, 100A AC @ 60% Duty Cycle, EN60974-7 .020" to 3/32" 0.5mm-2.4mm Electrodes

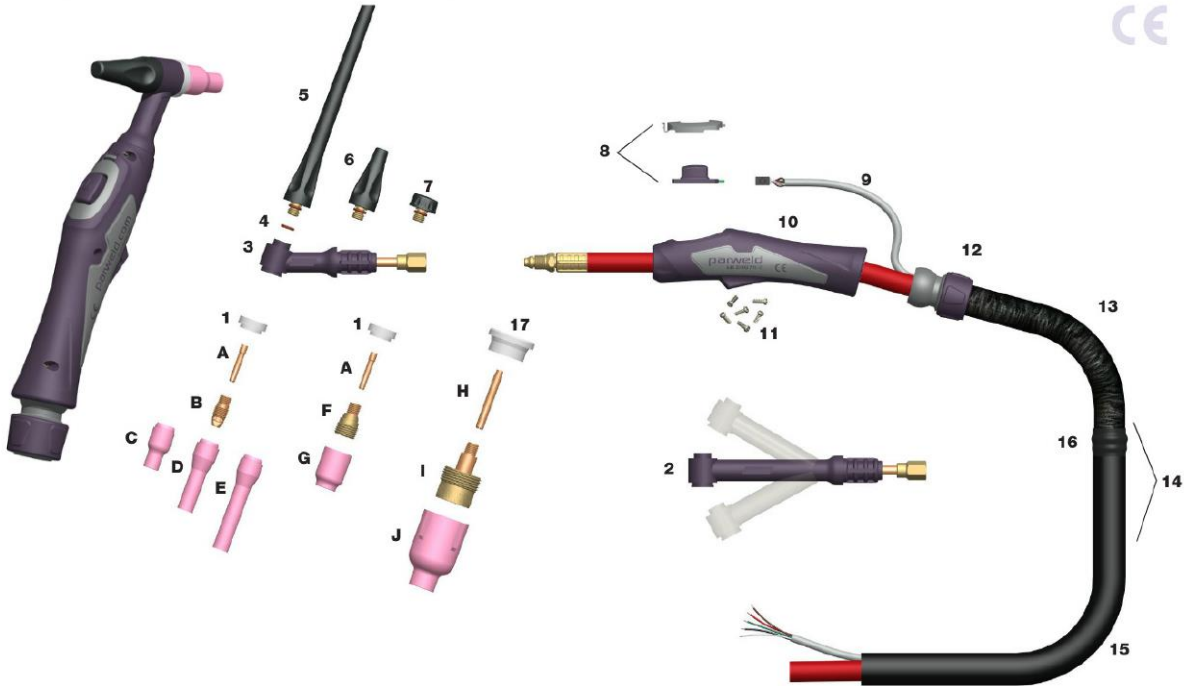

Pro-Grip™

Torch Head		
Stock Code	Description	
PRO9	PRO9	Torch Head Air Cooled 125A DC
PRO9FXL	PRO9FXL	Torch Head Flexible Air Cooled 125A DC

Cable Length		
Stock Code	Description	
12	12.5ft Cables (4m)	c/w Leather Cover and Sheath
25	25ft Cables (8m)	c/w Leather Cover and Sheath

Switch Option	
Stock Code	Description
S1	Momentary Switch
S1L	Momentary Switch and Lever
S2	2 Button Momentary
S3	3 Button Momentary
S4	4 Switch Momentary Rocker Kit
1K	1 Button Momentary +1K Potentiometer
2K	1 Button Momentary +5K Potentiometer
3K	1 Button Momentary +10K Potentiometer
4K	1 Button Momentary +25K Potentiometer
N	Blank

Cable Termination	
UK/European Cable Termination	
Stock Code	Description
BG	Single 3/8" BSP Connection
EG	Central Connector
WG	WTG Connector
LG	L-TEC Euro
BD	35-50 Dinse on Power 3/8" BSP on gas

USA Cable Termination	
Stock Code	Description
US	Lug on power, 5/8" UNF RH Male on Gas
UN	Single 5/8" UNF RH male
UD	35-95 dinse on power, 5/8" UNF RH Male on Gas

Cable Plug	
Stock Code	Description
0	2 Pin Amphenol Plug
1	4 Pin Amphenol Plug
2	5 Pin Amphenol Plug
3	6 Pin Amphenol Plug
4	14 Pin Amphenol Plug
5	6 Pin Harting Plug
6	8 Pin Thermal Arc Plug
7	3 Pin Tuchel Plug
8	9 Pin Tuchel Plug
9	5 Pin Tuchel Plug
10	12 Pin Bundy Plug
11	7 Pin Migatronic Plug
12	2 Pin XTI Inverter Plug
14	5 Pin XTI Inverter Plug

PROLINE

professional welding supplies

Standard Collet

Stock Code Description

A	13N20	Standard Collet .020"/0.5mm Bore
	13N21	Standard Collet .040"/1.0mm Bore
	13N22	Standard Collet 1/16"/1.6mm Bore
	13N22M	Standard Collet 5/64"/2.0mm Bore
	13N23	Standard Collet 3/32"/2.4mm Bore

Standard Collet Body

Stock Code Description

B	13N25	Standard Collet Body .020"/0.5mm Bore
	13N26	Standard Collet Body .040"/1.0mm Bore
	13N27	Standard Collet Body 1/16"/1.6mm Bore
	13N27M	Standard Collet Body 5/64"/2.0mm Bore
	13N28	Standard Collet Body 3/32"/2.4mm Bore

Standard Ceramic Cup

Stock Code Description

C	13N08	Standard Ceramic Cup 1/4"/6mm Bore
	13N09	Standard Ceramic Cup 5/16"/8mm Bore
	13N10	Standard Ceramic Cup 3/8"/10mm Bore
	13N11	Standard Ceramic Cup 7/16"/11mm Bore
	13N12	Standard Ceramic Cup 1/2"/15mm Bore
	13N13	Standard Ceramic Cup 5/8"/16mm Bore

Long Ceramic Cup

Stock Code Description

D	796F70	Long Ceramic Cup 3/16"/5mm Bore
	796F71	Long Ceramic Cup 1/4"/6mm Bore
	796F72	Long Ceramic Cup 5/16"/8mm Bore
	796F73	Long Ceramic Cup 3/8"/10mm Bore

Extra Long Ceramic Cup

Stock Code Description

E	796F74	Extra Long Ceramic Cup 3/16"/5mm Bore
	796F75	Extra Long Ceramic Cup 1/4"/6mm Bore
	796F76	Extra Long Ceramic Cup 5/16"/8mm Bore
	796F77	Extra Long Ceramic Cup 3/8"/10mm Bore

Gas Lens Body

Stock Code Description

F	45V41	Gas Lens Body .020"/0.5mm Bore
	45V42	Gas Lens Body .040"/1.0mm Bore
	45V43	Gas Lens Body 1/16"/1.6mm Bore

Gas Lens Cup

Stock Code Description

G	53N58	Standard Gas Lens Cup 1/4"/6mm Bore
	53N59	Standard Gas Lens Cup 5/16"/6mm Bore
	53N60	Standard Gas Lens Cup 3/8"/8mm Bore
	53N61	Standard Gas Lens Cup 7/16"/10mm Bore
	53N61-S	Standard Gas Lens Cup 1/2"/13mm Bore

Large Diameter Gas Lens Collet

Stock Code Description

H	13N22L	Large Dia Gas Lens Collet 1/16"/1.6mm Bore
	13N23L	Large Dia Gas Lens Collet 3/32"/2.4mm Bore

Large Diameter Gas Lens Body

Stock Code Description

I	45V116S	Large Dia Gas Lens Body 1/16"/1.6mm Bore
	45V64S	Large Dia Gas Lens Body 3/32"/2.4mm Bore

Large Diameter Gas Lens Cup

Stock Code Description

J	57N75	Large Dia Gas Lens Cup 3/8"/10mm Bore
	57N74	Large Dia Gas Lens Cup 1/2"/13mm Bore
	53N88	Large Dia Gas Lens Cup 5/8"/16mm Bore
	53N87	Large Dia Gas Lens Cup 3/4"/19mm Bore

Components

Stock Code Description

1	598882	Cup Gasket
2	PRO9FXL	Torch Head Flexible
3	PRO9	Torch Head including Cup Gasket
4	98W77	Back Cap O Ring
5	PRO41V24	Pro-Grip™ Tig Back Cap Long
6	PRO41V35	Pro-Grip™ Tig Back Cap Medium
7	PRO41V33	Pro-Grip™ Tig Back Cap Small
8	PRO1MS	Momentary Switch Kit (fitted as Standard) Alternative switch options are listed on Page 137
9	PROSWL4	Switch & Leads x 4mt/12.5ft
	PROSWL8	Switch & Leads x 8mt/25ft
10	PROH100	Pro-Grip™ Tig Handle Small
11	PROSP	Screw Pack
12	PROKJ100	Knuckle Joint c/w Lock Nut
13	PROLC100-08	Leather Cover x 0.8mt/2.6ft
14	PROCO100-40	Complete Cover Assembly x 4mt/12.5ft
	PROCO100-80	Complete Cover Assembly x 8mt/25ft
15	PRONC32	Neoprene Cover x 3.2mt/10.5ft
	PRONC72	Neoprene Cover x 7.2mt/23.6ft
16	PROJK100	Jointing Repair Kit
17	54N63-20	Insulator Large Diameter Gas Lens

Ph: 0800 699 353

sales@prolinewelding.com

New PRO20 and PRO20FXL

Water Cooled Pro-Grip™ Tig Welding Torch

Rating: 250A DC, 190A AC @ 100% Duty Cycle, EN60974-7 .020" to 1/8"/0.5mm-3.2mm Electrodes

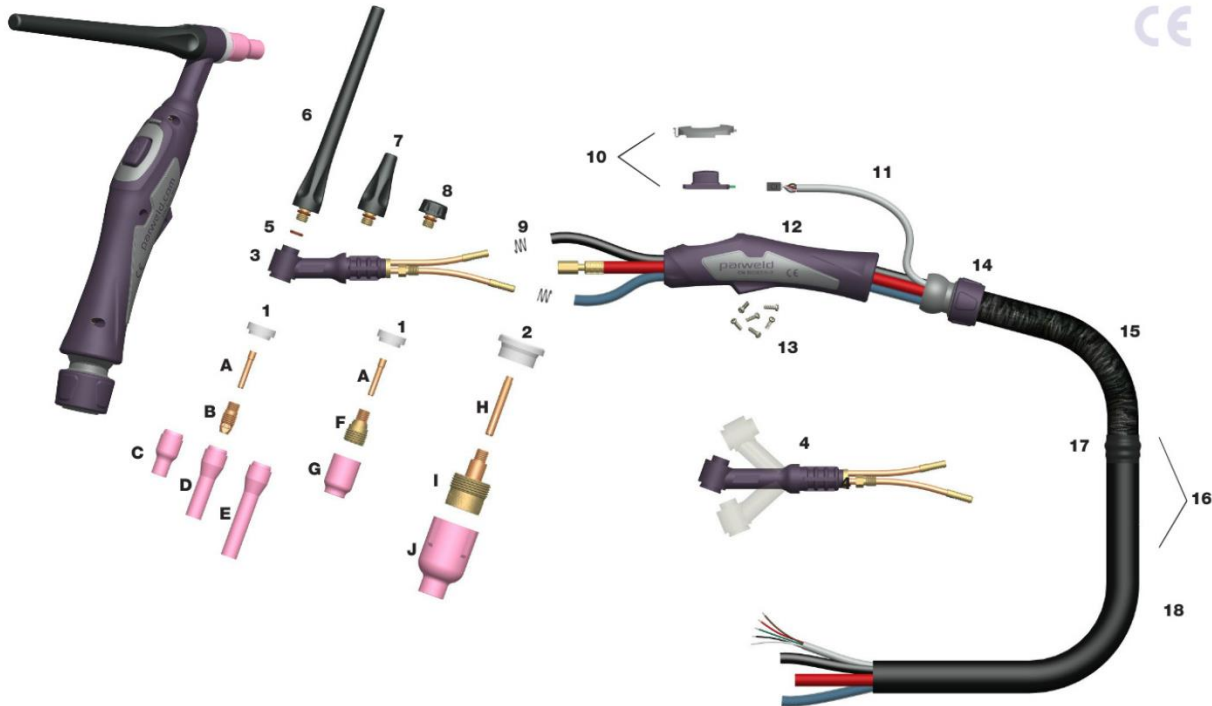

Torch Head

Stock Code Description

PRO20	Torch Head Water Cooled 250A DC
PRO20FXL	Torch Head Flexible Water Cooled 250A DC

Cable Length

Stock Code Description

12	12.5ft Cables (4m) c/w Leather Cover and Neoprene Sheath
25	25ft Cables (8m) c/w Leather Cover and Neoprene Sheath

Switch Option

Stock Code Description

S1	Momentary Switch
S1L	Momentary Switch and Lever
S2	2 Button Momentary
S3	3 Button Momentary
S4	4 Switch Momentary Rocker Kit
1K	1 Button Momentary +1K Potentiometer
2K	1 Button Momentary +5K Potentiometer
3K	1 Button Momentary +10K Potentiometer
4K	1 Button Momentary +25K Potentiometer
N	Blank

Cable Termination

UK/European Cable Termination

Stock Code Description

BW	3/8" BSP On Water, Gas, Power
DQ	35-95 Dinse, Quick fit Water In/Out, 3/8" BSP Gas
EW	Central Connector
WW	WTW Connector
LW	L-TEC Euro

USA Cable Termination

Stock Code Description

UW	7/8" UNF LH male on power, 5/8" UNF RH male on gas, 5/8" UNF LH male on water
UE	35-95 Dinse on power, 5/8" UNF LH on water In/Out, 5/8" UNF RH male on gas

Cable Plug

Stock Code Description

0	2 Pin Amphenol Plug
1	4 Pin Amphenol Plug
2	5 Pin Amphenol Plug
3	6 Pin Amphenol Plug
4	14 Pin Amphenol Plug
5	6 Pin Harting Plug
6	8 Pin Thermal Arc Plug
7	3 Pin Tuchel Plug
8	9 Pin Tuchel Plug
9	5 Pin Tuchel Plug
10	12 Pin Bundy Plug
11	7 Pin Migatron Plug
12	2 Pin XTI Inverter Plug
14	5 Pin XTI Inverter Plug

For the complete range of Cable Terminations and Plugs please refer to Page 179-187

PROLINE

professional welding supplies

Standard Collet		
Stock Code	Description	
A 13N20	Standard Collet .020"/0.5mm Bore	
13N21	Standard Collet .040"/1.0mm Bore	
13N22	Standard Collet 1/16"/1.6mm Bore	
13N22M	Standard Collet 5/64"/2.0mm Bore	
13N23	Standard Collet 3/32"/2.4mm Bore	
13N24	Standard Collet 1/8"/3.2mm Bore	

Standard Collet Body		
Stock Code	Description	
B 13N25	Standard Collet Body .020"/0.5mm Bore	
13N26	Standard Collet Body .040"/1.0mm Bore	
13N27	Standard Collet Body 1/16"/1.6mm Bore	
13N27M	Standard Collet Body 5/64"/2.0mm Bore	
13N28	Standard Collet Body 3/32"/2.4mm Bore	
13N29	Standard Collet Body 1/8"/3.2mm Bore	

Standard Ceramic Cup		
Stock Code	Description	
C 13N08	Standard Ceramic Cup 1/4"/6mm Bore	
13N09	Standard Ceramic Cup 5/16"/8mm Bore	
13N10	Standard Ceramic Cup 3/8"/10mm Bore	
13N11	Standard Ceramic Cup 7/16"/11mm Bore	
13N12	Standard Ceramic Cup 1/2"/13mm Bore	
13N13	Standard Ceramic Cup 5/8"/16mm Bore	

Long Ceramic Cup		
Stock Code	Description	
D 796F70	Long Ceramic Cup 3/16"/5mm Bore	
796F71	Long Ceramic Cup 1/4"/6mm Bore	
796F72	Long Ceramic Cup 5/16"/8mm Bore	
796F73	Long Ceramic Cup 3/8"/10mm Bore	

Extra Long Ceramic Cup		
Stock Code	Description	
E 796F74	Extra Long Ceramic Cup 3/16"/5mm Bore	
796F75	Extra Long Ceramic Cup 1/4"/6mm Bore	
796F76	Extra Long Ceramic Cup 5/16"/8mm Bore	
796F77	Extra Long Ceramic Cup 3/8"/10mm Bore	

Gas Lens Body		
Stock Code	Description	
F 45V41	Gas Lens Body .020"/0.5mm Bore	
45V42	Gas Lens Body .040"/1.0mm Bore	
45V43	Gas Lens Body 1/16"/1.6mm Bore	
45V44	Gas Lens Body 3/32"/2.4mm Bore	
45V45	Gas Lens Body 1/8"/3.2mm Bore	

Gas Lens Cup		
Stock Code	Description	
G 53N58	Standard Gas Lens Cup 1/4"/6mm Bore	
53N59	Standard Gas Lens Cup 5/16"/8mm Bore	
53N60	Standard Gas Lens Cup 3/8"/10mm Bore	
53N61	Standard Gas Lens Cup 7/16"/11mm Bore	
53N61-S	Standard Gas Lens Cup 1/2"/13 mm Bore	

Large Diameter Gas Lens Collet		
Stock Code	Description	
H 13N22L	Large Diameter Gas Lens Collet 1/16"/1.6mm Bore	
13N23L	Large Diameter Gas Lens Collet 3/32"/2.4mm Bore	

Large Diameter Gas Lens Body		
Stock Code	Description	
I 45V116S	Large Diameter Gas Lens Body 1/16"/1.6mm Bore	
45V64S	Large Diameter Gas Lens Body 3/32"/2.4mm Bore	

Large Diameter Gas Lens Cup		
Stock Code	Description	
J 57N75	Large Diameter Gas Lens Cup 3/8"/10mm Bore	
57N74	Large Diameter Gas Lens Cup 1/2"/11mm Bore	
53N88	Large Diameter Gas Lens Cup 5/8"/16mm Bore	
53N87	Large Diameter Gas Lens Cup 3/4"/19mm Bore	

Components		
Stock Code	Description	
1 598882	Cup Gasket	
2 54N63-20	Insulator Large Diameter Gas Lens	
3 PRO20	Torch Head including Cup Gasket	
4 PRO20FXL	Torch Head Flexible	
5 98W77	Back Cap O Ring	
6 PRO41V24	Pro-Grip™ Tig Back Cap Long	
7 PRO41V35	Pro-Grip™ Tig Back Cap Medium	
8 PRO41V33	Pro-Grip™ Tig Back Cap Small	
9 53N04	Wire Clamps	
10 PRO1MS	Momentary Switch Kit (fitted as Standard) Alternative switch options are listed on Page 137	
11 PROSWL4	Connector Leads x 4mt/12.5ft	
PROSWL8	Connector Leads x 8mt/25ft	
12 PROH100	Pro-Grip™ Tig Handle Small	
13 PROSP	Screw Pack	
14 PROKJ100	Knuckle Joint c/w Lock Nut	
15 PROLC100-08	Leather Cover x 0.8mt/2.6ft	
16 PROCO100-40	Complete Cover Assembly 4mt/12.5ft	
PROCO100-80	Complete Cover Assembly x 8mt/25ft	
17 PROJK100	Jointing Repair Kit	
18 PRONC-32	Neoprene Cover x 3.2mt/10.5ft	
PRONC-72	Neoprene Cover x 7.2mt/23.6ft	

Pro-Grip™